



MS11 Adjustable Range, Stainless Steel Microwave Touchless Actuator



*Wave Goodbye to Germs
Say Hello to Touchless Activation*

MS11 Touchless Solution

Ideal For Harsh Environment

- IP65 rated enclosure capable of use in industrial and extreme washdown environments

High-Visibility

- Illuminated blue center changes to green upon signal reception / activation

Adjustable Detection Zone

- Adjustable Detection Zone

Activation Alerts

- Adjustable audible alert setting, including silent-mode required for hospitals and other noise-sensitive environments

Adjustable Hold Time

- Configurable output hold time of 1 – 30 seconds allowing unique, user-defined device placement

Universally Compatible With Automatic Doors

- Compatible with all automatic door control makes and models

The MS11 is an aesthetically pleasing, touchless activation device designed to reduce the spread of germs and improve accessibility in healthcare, retail, industrial and commercial settings. The MS11 has been purpose-built to withstand the extreme rigors of fast-paced and sanitary environments.

The flush-mount MS11 is a durable stainless steel device utilizing adjustable-range microwave technology.

The MS11's illuminated center and audible signaling confirms activation and encourages proper touchless use.

The MS11 detects moving objects such as a hand, cart or wheelchair and is designed for use in hospitals, pharmacies, clean rooms, food service and other areas needing highly accessible and germ-free activation.

Touchless Solution Eliminates Spread of Germs

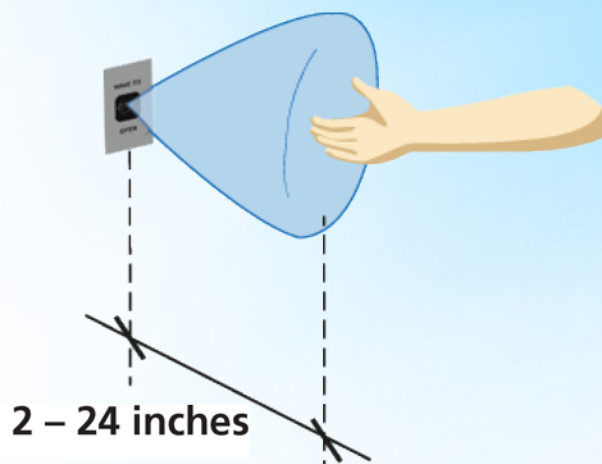

MS11 Adjustable Range, Stainless Steel Microwave Touchless Actuator

West: 800-544-4422 • East: 800-225-6737

Applications

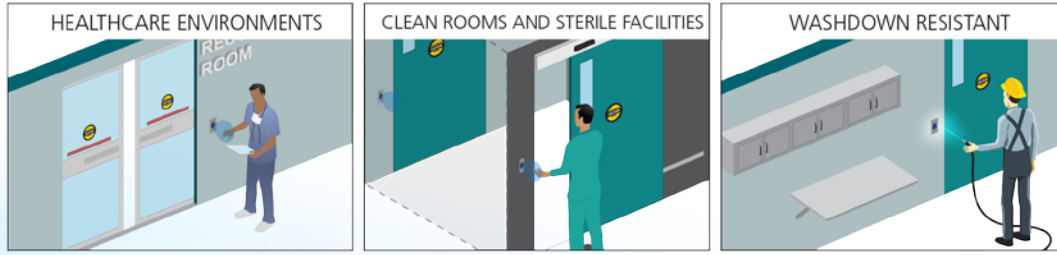

Dimensional Drawings

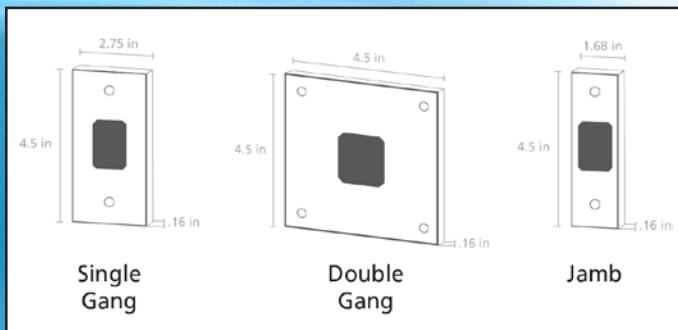

Related Products



10MS11S
STAINLESS STEEL
SINGLE GANG



10MS11J
STAINLESS STEEL
JAMB STYLE



10MS11D
STAINLESS STEEL
DOUBLE GANG



10MS11SW
WHITE POWDERCOAT
SINGLE GANG



10MS11JW
WHITE POWDERCOAT
JAMB STYLE



10MS11DW
WHITE POWDERCOAT
DOUBLE GANG



10RD900
900 MHZ RECEIVER

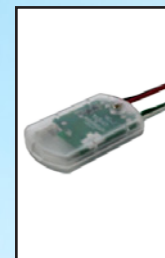

10TD900TR
900 MHZ RETROFIT
TRANSMITTER



10ABOXSGMS
SINGLE GANG ANGLED
MOUNTING BOX

Technical Specifications	
Technology	Microwave Doppler Radar
Detection Mode	Motion (bidirectional), Toggle or Timed Mode
Sensing Zone **	2 in – 24 in (adjustable)
Hold Time	1 s – 30 s
Supply Voltage	12 – 24 VAC / VDC or 5 VDC
Current Consumption	< 2.8 W
Temperature Range	-22 °F – 158 °F
Enclosure Rating	NEMA 4 / IP65
Relay	1-Form C Solid State Relay 1 A 30 VAC / VDC (max)
Dimensions	
Single Gang	2.75 in (W) × 4.5 in (H) × 0.98 in (D)
Double Gang	4.5 in (W) × 4.5 in (H) × 0.98 in (D)
Jamb	1.68 in (W) × 4.5 in (H) × 0.98 in (D)
Wire Harness Length	12 in
Material	Stainless Steel (faceplate) / ABS (center)

** See User's Guide



10TD900TR 900 MHz Retrofit Transmitter

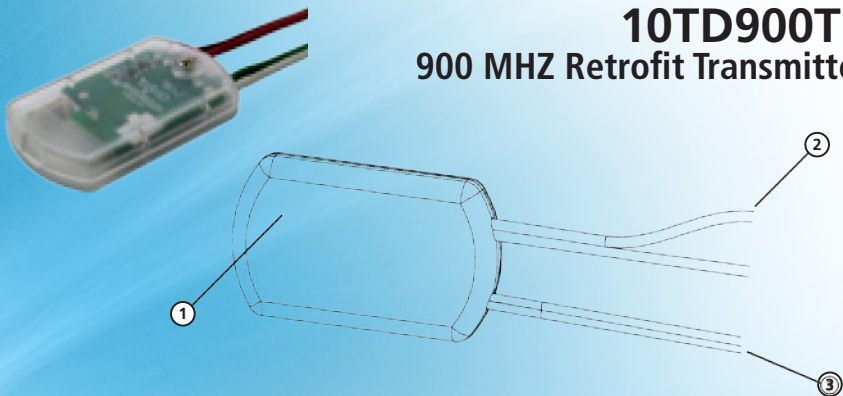

Ideal For Harsh Environment

1. 900 MHz Wireless Transmitter
2. White and Green Activation Wires
3. Red and Black Power Wires

Precautions

- Shut off all power going to header before attempting any wiring procedures.
- Maintain a clean and safe environment when working in public areas.
- Constantly be aware of pedestrian traffic around the door area.
- Always stop pedestrian traffic through the doorway when performing tests that may result in unexpected reactions by the door.
- ESD (electrostatic discharge): Circuit boards are vulnerable to damage by electrostatic discharge. Before handling any board, ensure you dissipate your body's ESD charge.
- Always check placement of all wiring before powering up to ensure that moving door parts will not catch any wires and cause damage to equipment.
- Ensure compliance with all applicable safety standards (i.e. ANSI A156.10) upon completion of installation.
- DO NOT attempt any internal repair of the components. All repairs and/or component replacements must be performed by BEA, Inc. Unauthorized disassembly or repair:
 1. May jeopardize personal safety and may expose one to the risk of electrical shock.
 2. May adversely affect the safe and reliable performance of the product resulting in a voided warranty.

In most applications for existing hard-wired touch push plates, only two (2) wires are installed which run within the wall from the push plate to the door control for activation. The 900 MHz Touchless Retrofit Transmitter allows an existing, hard-wired, touch push plate to be retrofitted with a new touchless plate that requires four (4) wires (2 wires for power and 2 wires for activation) without running additional wires. This is achieved by use of a powered wireless transmitter and wireless receiver.

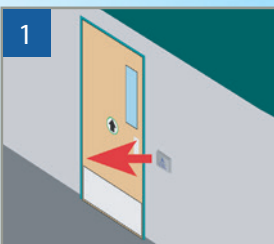

1 Remove existing touch push plate and disconnect the two (2) existing in-wall wires from the push plate and door control activation.

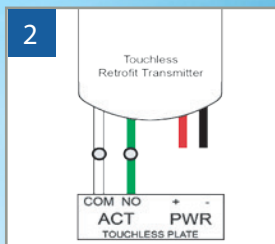

2 Connect the green and white wires to the new touchless plate activation output.

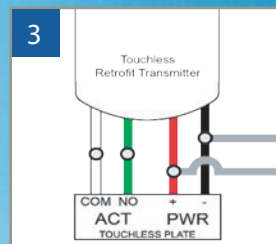

3 Parallel the red and black wires with the two (2) existing in-wall wires and connect them to the new touchless plate power input.



4 Mount new touchless plate.

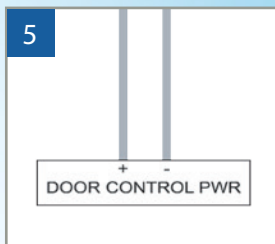

5 Connect the two (2) existing in-wall wires to the power source in the door control header.

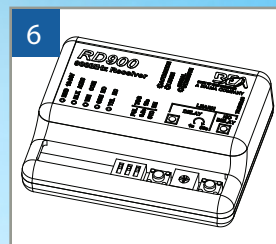

6 Install the 900 MHz wireless receiver in the header (sold separately).

Technical Specifications

Power	12 – 24 VAC/VDC ±10%
Transmitter Frequency	908 – 918 MHz (frequency hopping)
Emitted radio power	-25 dBm
Power consumption	22 mA
Temperature range	14 – 131 °F (-10 – 55 °C)
LEDs	Red (activation)
Dimensions:	1.72" (L) x 1.06" (W) x 0.32" (T)
Material	ABS Plastic
Certification	FCC, IC